

**RUTHERFORD COUNTY SCHOOL SYSTEM**  
**2240 Southpark Drive**  
**Murfreesboro, TN 37128**

**November 13, 2019**  
**5:00 P.M.**

**1. CALL TO ORDER**

**2. PLEDGE OF ALLEGIANCE**

**3. MOMENT OF SILENCE**

**4. APPROVAL OF AGENDA**

**Recommended Approval---motion to approve the agenda as presented.**

**5. APPROVAL OF CONSENT AGENDA (TAB 1)**

**A. Minutes: October 24, 2019 Board Meeting**

**B. Community Use of Facilities**

**C. Transportation: Bus #261 requesting voluntary termination of contract**

**D. Title I Contracts**

- **Julie Taylor with A+ Literacy Consulting Agreement**

**E. Routine Bids**

**Bid #3444 – Washington DC Trip (Thurman Francis)**

**Request to Purchase:**

**Rutherford County Board of Education request to use Wilson County Bid Contract #51AHO for technology hardware purchases through Dell.**

**F. School Salary Supplements and Contract Payments:**

<b>Name</b>	<b>Amount</b>	<b>School</b>	<b>Funded By</b>	<b>Description</b>
Kevin Gregory (6)	NTE \$1,000.00	Blackman Middle	School Funds- Various	Bus Driver

Shawn Lee	NTE \$500.00	Blackman Middle	School Funds-Girls + Boys Basketball	Bookkeeper for the 2019/20 Season
Charlie Miller	NTE \$500.00	Blackman Middle	School Funds-Girls + Boys Basketball	Clock Operator for the 2019/20 Season
Steve McClanahan	NTE \$3,500.00	Riverdale High School	Football Boosters	Football Summer Maintenance
Barry Messer	NTE \$6,500.00	Riverdale High School	Baseball Boosters	Mowing Baseball field – 2018/2019 +2019/2020 season
Barry Messer	NTE \$1,500.00	Riverdale High School	Baseball Boosters	Baseball Camp
Joshua Pelchat	NTE \$3,000.00	Riverdale High School	Football Boosters	Football Summer Maintenance
Danielle Clark	NTE \$2,000.00	Rock Springs Elementary	Universal Sports League	Opening gym on Saturdays for Universal Sports League Basketball season
Richie Conner (6)	NTE \$2,000.00	Rockvale High School	School Funds-Variou	Bus Driver
Richie Conner (6)	NTE \$3,000.00	Rockvale Middle School	School Funds-Variou	Bus Driver
Loren Emery	NTE \$500.00	Rocky Fork Middle School	School Funds-Archery	Assistant Archery Coach
Trisha Frazer	NTE \$1,000.00	Siegel High School	School Funds-Cross Country	Assistant Cross Country Coach
Jonathan Tolbert (6)	NTE \$1,500.00	Smyrna High School	School Funds-Variou	Bus Driver
Camille Gray	NTE \$1,000.00	Whitworth Buchanan	School Funds-Girls + Boys Basketball	Bookkeeper for the 2019/20 Season
Covin Skelton	NTE \$1,000.00	Whitworth Buchanan	School Funds-Girls + Boys Basketball	Clock Operator for the 2019/20 Season
Dustin Schletzer	\$25/Lesson	Blackman Middle	School Funds-Band	Private Percussion Lessons
Keya Magiala	\$20/Lesson	Oakland Middle	School Funds-Band	Private Lessons
Kyle Meares	NTE \$1,600.00	Oakland Middle	School Funds-Choir/Theater	Sound Engineer/Accompanist

Michael Prevost	NTE \$800.00	Riverdale High School	School Funds- Boys Basketball	Assistant Boys Basketball Coach
Durell Fain	NTE \$1,200.00	Rocky Fork Middle	School Funds- Football	Assistant Football Coach
Jacob Brashar	NTE \$500.00	Siegel High School	School Funds- Choir	Choreography for Spring Musical
Casey Brefka	NTE \$3,000.00	Siegel High School	Siegel HS Band Boosters	Direct after school Jazz Band
Megan Gaspardo	NTE \$1,400.00	Siegel High School	School Funds- Cross Country	Assistant Cross Country Coach
Erika Moss	NTE \$3,000.00	Siegel High School	Siegel Volleyball Boosters	Assistant Volleyball Coach
Paul Torres	NTE \$1,000.00	Siegel High School	School Funds- Cross Country	Assistant Cross Country Coach
Alison Allerton	NTE \$800.00	Stewarts Creek High	School Funds- All County Choir	All-County Clinician
Matti Berhow	NTE \$500.00	Stewarts Creek High	School Funds- Swimming	JV Head Swimming coach + Varsity Assistant Swimming Coach
Matthew Jefferson	NTE \$10,000.00	Stewarts Creek High	SCHS Music Boosters	Trombone Lessons + Coaching
Susan Marie Kelly	NTE \$800.00	Stewarts Creek High	School Funds- All County Choir	All-County Clinician
Charles Mitchell	NTE \$2,212.00	Stewarts Creek High	School Funds- Baseball	Assistant Pitching Coach
Ambria Gonzalez (2)	Hourly	Cedar Grove	Clubs, Athletics + Outside Groups	Additional Custodial work for the 2019/2020 school year
Jane Wallick (2)	Hourly	Christiana Elementary	Clubs, Athletics + Outside Groups	Additional Custodial work for the 2019/2020 school year

Brandon Utley (2)	Hourly	Oakland High School	Clubs, Athletic + Outside Groups	Additional Custodial work for the 2019/2020 school year
James Lewis (2)	Hourly	Siegel High School	Clubs, Athletics + Outside Groups	Additional Custodial work for the 2019/2020 school year

\*\* Unless listed as an hourly rate

1. Approved previously for an amount \$500 or greater
2. Not less than regular hourly rate – or overtime rate if working over 40 hours during the week
3. Anticipate amounts over \$500 this school year
4. Amend prior approval
5. Less than \$500 but part of event total
6. Pending approval by Transportation Dept.

#### **G. Non-Faculty Volunteer Coaches:**

According to Tennessee Secondary School Athletic Association (TSSAA) guidelines, Board of Education approval is required to allow non-faculty volunteer coaches to participate in the school athletic programs.

The following non-faculty volunteer coaches are for the 2019-2020 school year:

<u>Name</u>	<u>School</u>	<u>Sport</u>
Jacob Brasher	Siegel High School	Choir
Cassey Brefka	Siegel High School	Band
Benjamin Hans	Thurman Francis	Band
Matthew Jefferson	Stewarts Creek High School	Band
Dustin Schletzer	Blackman Middle School	Band
Kenneth Harless	Stewarts Creek High School	Wrestling
Telly Coleman	LaVergne High School	Swimming
Joey Golliver	Siegel High School	Softball
Jaylen Johnson	Smyrna High School	Basketball
Timothy Cole	Eagleville	Basketball/Boys
Willie Thomas	Siegel High School	Basketball
Dylan Coggins	Stewarts Creek High School	Wrestling
Kahlia Jordan	LaVergne High School	Swimming
Joshua Phillips	Rockvale High School	Wrestling
Torent Miller	Oakland Middle School	Basketball

**Recommended Approval---**motion to approve the consent agenda items as presented.

#### **6. VISITORS**

#### **7. SPOTLIGHT**

##### **Middle School Teacher Externship**

**8. RECOGNITION**

- **Smyrna High School**

**Coach Carl Syler – TSSAA 2018-19 Boys Bowling Coach of the Year**

- **Smyrna High School**

**2018-19 Boys Bowling Team Division I State Champions  
2019 National Champions**

**9. EDUCATIONAL EPHIPHANY, LLC AGREEMENT (TAB 2)**

**Dr. Donyall Dickey will present a workshop, team planning and deconstructing standards on Dec 9<sup>th</sup>, 2019. This training follows District Goal 3: increasing achievement scores and reaching AMO targets and Goal 4: training effective teachers and district instructional leaders. Instructional coaches will disperse training into each of their schools.**

**The total cost for the training day is \$5,500 for the presenter. Title II funds will pay for 100% of the cost.**

**Recommended Approval---motion to approve a contract between Educational Epiphany, LLC and the Rutherford County Schools for the following teacher training workshop as presented.**

**10. JOHN COLEMON ANNEX/HEAD START (TAB 3)**

**Currently, Rutherford County Schools house a Head Start program in around half of the John Coleman Elementary Annex Building under a lease agreement held by Mid-Cumberland Head Start. On October 31, 2019, Mid-Cumberland Head Start passed operation responsibilities to a new interim management group, CDI. CDI has requested that RCS enter a lease with CDI containing the same or similar terms as that in place with Mid-Cumberland Head Start. It is within the Board's discretion to start the process of terminating the lease with a 90-day notice, ending it at the end of the current school year or extending a new lease.**

**Recommended Approval—to discuss whether the Board wishes to either allow Head Start to continue operation in the John Coleman Annex Building, or whether the Board wishes to deny the request for a lease. The Board may make a motion based on its discussion.**

**11. STEWARTS CREEK HIGH SCHOOL EXPLORATORY COMMITTEE**

**Stewarts Creek High school would like to form a committee to examine the formation of a booster club. The goal of the club will be to potentially raise funds for the construction of a batting facility for the baseball and softball teams. Stewarts Creek High School seeks the Boards approval as a preliminary step to obtain any Board feedback prior to parents expending funds to form the booster itself. If the committee determines that a formal booster club will be needed, it will resubmit all formation documentation for this Board's review and formal approval.**

**Recommended Approval---motion to approve the formation of the SCHS exploratory committee**

**12. DISCIPLINARY HEARING APPEALS**

**A. The Board has been requested to review the October 18, 2019 decision of the Disciplinary Hearing Authority (DHA) to uphold the remandment of a student from Siegel Middle School. The student was remanded to alternative school under Board Policy 6.313 for making an inappropriate comment about bringing a gun to school. Based on a review of the DHA's record, the Board may:**

- 1. Affirm the decision of the DHA;**
- 2. Overturn the decision of the DHA;**
- 3. Modify the decision to a lesser penalty; or**
- 4. Grant a hearing before the Board**

**B. DISCIPLINARY HEARING APPEAL**

**The Board has been requested to review the October 18, 2019 decision of the Disciplinary Hearing Authority (DHA) to uphold the remandment of a student from Oakland High School. The student was remanded to alternative school under Board Policy 6.313 for making electronic death threats. Based on a review of the DHA's record, the Board may:**

- 1. Affirm the decision of the DHA;**
- 2. Overturn the decision of the DHA;**
- 3. Modify the decision to a lesser penalty; or**
- 4. Grant a hearing before the Board**

### 13. FACILITIES USE APPROVED FOR EXEMPTION

**Pursuant to Board Policy 3.206 public education schools and institutions, post-secondary education institutions, private universities and colleges, governmental entities or agencies that provide benefits to the Rutherford County School System or have an in-kind relationship approved by the Director of Schools may request the Board of Education to allow an exemption from the use of facilities fee which the Board may allow or deny based upon the details of the specific request.**

**Recommended Approval---motion to approve the following groups requesting fee waivers for the use of facilities to Policy 3.206:**

Cub Scouts Pack 482	Pinewood Derby (Stewartsboro)
Girl Scouts Troops 2432 & 2728	Meetings (Browns Chapel)
Troop 1549	Holiday Extravaganza (Browns Chapel)
Troop 70	Meetings (Rock Springs Elem)
Troop 154	Meetings (Rock Springs Middle)
	Meetings and Training (Stewartsboro)
Smyrna Junior Basketball League	2019-2020 Season (games-Rocky Fork Middle, Stewartsboro; practices-Browns Chapel, Stewartsboro, Stewarts Creek Elementary)

Note: Facility use for 11/13/19 has been granted pending Board action. A certificate of insurance with \$2,000,000.00 limits (\$1,000,000.00) if approved) is required by each user. Each group must forward any renewals of insurance to the Board on time; otherwise approval is terminated at the end of the policy period. All approvals are for no more than a 1-year period.

### 14. FINANCIAL MATTERS (TAB 4)

#### 1. Additional Clerical Position for Attendance Office

**The Attendance Office is requesting one additional clerical position. This position will be the first new clerical position for the attendance office in a decade and be budgeted at a Skill Level 4 pay grade. The budget amendment for this position will be brought later.**

**Recommended Approval---motion to approve one additional full-time Attendance Office Clerical staff position. Budget amendment for this position to be brought later from growth funds.**

#### 2. Discussion of outstanding credit balance of School Nutrition Meal Charges as of November 1, 2019

**15. FACILITIES (TAB 5)**

- **Blackman Middle School:**

**Dr. Connifey-Marlin is requesting to pour concrete for bleacher support at the girls' softball field at a cost of \$2,000.00 labor and the material is being donated by Smyrna Ready Mix. This request is at no cost to the Board. Engineering and Construction has reviewed this request and finds it acceptable.**

**Recommended Approval---motion to approve the construction of a concrete pad for Blackman Middle Softball at no cost to the Board.**

- **Rockvale High School:**

**Rockvale High School principal Steve Luker is requesting to install a partial obstacle course for the ROTC program at no cost to the Board. Engineering and Construction has reviewed this request and finds it acceptable.**

**Recommended Approval---motion to approve the installation of a partial ROTC obstacle Course at no cost to the Board.**

- **Rockvale High and Rockvale Middle:**

**Principals Luker and Barlow are requesting to purchase a joint use 12' x 16' storage building for athletics for \$3,675.00 off County Bid at no cost to the board. Cost is to be 50/50 between the schools. Engineering and Construction has reviewed this request and finds it acceptable.**

**Recommended Approval---motion to approve the purchase of a joint use storage building for Athletics at no cost to the Board.**

**16. INSURANCE UPDATE**

**17. DIRECTOR'S UPDATE**

**18. TENNESSEE LEGISLATIVE NETWORK (TLN) UPDATE**

**19. FEDERAL RELATIONS NETWORK (FRN) UPDATE**

**20. GENERAL DISCUSSION**

**21. ADJOURNMENT**



**RUTHERFORD COUNTY SCHOOL SYSTEM  
Board of Education Meeting  
2240 Southpark Drive  
Murfreesboro, TN 37128**

**Minutes of October 24, 2019**

**Board Members Present**

**Jim Estes, Board Chairman**

**Coy Young, Vice-Chairman**

**Terry Hodge**

**Tiffany Johnson**

**Jeff Jordan**

**Lisa Moore**

**Tammy Sharp**

**Bill C. Spurlock, Director of Schools**

**1. CALL TO ORDER**

**The Board Chairman called the meeting to order at 5:00 PM. Director Bill Spurlock led the Pledge of Allegiance.**

**2. MOMENT OF SILENCE**

**The Chairman called for a moment of silence.**

**3. APPROVAL OF AGENDA**

**Motion made by Mr. Hodge, seconded by Mr. Jordan, to approve the agenda as presented.**

**Vote: All Yes**

**4. APPROVAL OF CONSENT AGENDA**

**A. Minutes: October 3, 2019 Board Meeting**

**B. Community Use of Facilities**

**C. Title I Contracts**

- Julie Taylor with A+ Literacy Consulting Agreement with LaVergne Lake Elementary**
- Emotional Poverty Workshop with aha! Process, Inc.**

**D. Out of County Transfers (1)**

**E. Routine Bids**

**Bid #3439-Lincoln Torchmate 4800 CNC Plasma System**

**Bid #3440-Striping and Sealcoat**

**Bid #3441-Asbestos Abatement**

**Bid #3443-Bleacher Repairs (Blackman High)**

**Request to Purchase:**

The Engineering and Construction Department would like to repair and renovate the gymnasium floor at Wilson Elementary School in the amount of \$2,625.80. To be purchased from Praters, Inc. using Rutherford County Bid #3320. This is an approved project from Capital Project Funds.

**Request to Purchase:**

The Title I Department would like to purchase eighteen (18) ViewSonic IFP7550E2 Bundles which includes the interactive boards, stands, software, training and warranty for LaVergne Middle School in the amount of \$46,872.38. To be purchased from Troxell Communications, Inc. using Omnia Partners Contract #R160903. To be funded from the Title I Department.

**Request to Purchase:**

The Safe Schools Department would like to upgrade to the Avigilon Camera Systems at six high schools and seven elementary schools in the amount of \$318,000.00. To be purchased from System Integrations, Inc. using Rutherford County Bid #3353. To be funded from the Safe Schools Department.

**Request to Purchase:**

The Engineering and Construction Department would like to install Delta Controls on all existing HVAC systems from Maynard Select for Smyrna Middle in the amount of \$221,000.00 per Tennessee Code for Energy Efficiency #TCA 49-2-203. This is an approved project from Capital Project Funds.

**Request to Purchase:**

Rutherford County Board of Education request to use the following Cooperative Purchasing Agreements: Clinch-Powell Educational Cooperative (TIPS), E & I Cooperative Services, National Cooperative Purchasing Alliance (NCPA), NASPO Value Point, Omnia Partners (NIPA and U.S. Communities), and Sourcewell.

**F. School Salary Supplements and Contract Payments:**

<b>Name</b>	<b>Amount</b>	<b>School</b>	<b>Funded By</b>	<b>Description</b>
Courtney Gregory	NTE 3,000.00	Blackman High	School Funds-Varsity Cheerleading	Competition Cheer Coach/Football Cheer Advisor

Ralston Williams	NTE 1,500.00	Blackman High	School Funds-Football	Assistant Football Coach
Barry Wortman	NTE 6,000.00	Blackman High	School Funds-General Athletics	Boys Basketball Coach
Heather Wortman	NTE 3,000.00	Blackman High	School Funds-Varsity Cheerleading	Competition Cheer Coach
Maranda Allen	NTE 500.00	Blackman Middle	School Funds-Drama	Work with Drama Production
Casey Molina	NTE 500.00	Blackman Middle	School Funds-Drama	Work with Drama Production
Shelia Panther	NTE500.00	Blackman Middle	School Funds-Drama	Work with Drama Production
Krissa Seifert	NTE 500.00	Blackman Middle	School Funds-Drama	Work with Drama Production
Nicole Underwood	NTE 500.00	Blackman Middle	School Funds-Drama	Work with Drama Production
Lauren Fluharty	NTE 750.00	Central Magnet	School Funds-MS Girls Soccer	Assistant MS Girls Soccer Coach
Brandon Bassham	NTE 1,000.00	Eagleville	School Funds-HS/MS Basketball	HS/MS-JV Basketball Officiating
Shane Chapman	NTE1,000.00	Eagleville	School Funds-HS/MS Basketball	HS/MS-JV Basketball Officiating
Mac Jones	NTE 1,000.00	Eagleville	School Funds-HS/MS Basketball	HS/MS-JV Basketball Officiating
Alan Pepper	NTE 1,000.00	Eagleville	School Funds-HS/MS Basketball	HS/MS-JV Basketball Officiating
Joey Reed	NTE 1,000.00	Eagleville	School Funds-HS/MS Basketball	HS/MS-JV Basketball Officiating
Bo Tollett	NTE 1,000.00	Eagleville	School Funds-HS/MS Basketball	HS/MS-JV Basketball Officiating
Joseph Wilson	NTE 1,000.00	Eagleville	School Funds-HS/MS Basketball	HS/MS-JV Basketball Officiating
Brandon Bassham	NTE 2,500.00	Eagleville	School Funds-Jr Pro Basketball	Officiating for Jr. Pro Basketball at various county schools

Richard Bolden	NTE 2,500.00	Eagleville	School Funds- Jr Pro Basketball	Officiating for Jr. Pro Basketball at various county schools
Shane Chapman	NTE 2,500.00	Eagleville	School Funds- Jr Pro Basketball	Officiating for Jr. Pro Basketball at various county schools
Chris Lynch	NTE 2,500.00	Eagleville	School Funds- Jr Pro Basketball	Officiating for Jr. Pro Basketball at various county schools
Davy McClaran	NTE 2,500.00	Eagleville	School Funds- Jr Pro Basketball	Officiating for Jr. Pro Basketball at various county schools
Alan Pepper	NTE 2,500.00	Eagleville	School Funds- Jr Pro Basketball	Officiating for Jr. Pro Basketball at various county schools
Jennifer Snell	NTE 2,500.00	Eagleville	School Funds- Jr Pro Basketball	Officiating for Jr. Pro Basketball at various county schools
Bo Tollett	NTE 2,500.00	Eagleville	School Funds- Jr Pro Basketball	Officiating for Jr. Pro Basketball at various county schools
Brooke Wyant	NTE 2,500.00	Riverdale High	Riverdale Cheerleading Boosters	Cheer Coaching
Roger Haynes (1)	NTE 400.00	Siegel High	Siegel Band Boosters	Painting Football Field for Band
Craig Reavis	NTE 1,500.00	Siegel High	School Funds- Baseball	Off Season Field Maintenance
Craig Reavis	NTE 450.00	Siegel High	School Funds- Football	PA for home football games
Austin Bailey	NTE 1,000.00	Eagleville	School Funds- HS/MS Basketball	HS/MS-JV Basketball Officiating
Matthew Boyette	NTE 1,000.00	Eagleville	School Funds- HS/MS Basketball	HS/MS-JV Basketball Officiating
Ryleigh Cobb	NTE 1,000.00	Eagleville	School Funds- HS/MS Basketball	HS/MS-JV Basketball Officiating
Eric Hawks	NTE 1,000.00	Eagleville	School Funds- HS/MS Basketball	HS/MS-JV Basketball Officiating
Bobby Leathers	NTE 1,000.00	Eagleville	School Funds- HS/MS Basketball	HS/MS-JV Basketball Officiating

Ryley McClaren	NTE 1,000.00	Eagleville	School Funds- HS/MS Basketball	HS/MS-JV Basketball Officiating
Tim McGehee	NTE 1,000.00	Eagleville	School Funds- HS/MS Basketball	HS/MS-JV Basketball Officiating
Luke Parrish	NTE 1,000.00	Eagleville	School Funds- HS/MS Basketball	HS/MS-JV Basketball Officiating
Chris Payne	NTE 1,000.00	Eagleville	School Funds- HS/MS Basketball	HS/MS-JV Basketball Officiating
Cody Pepper	NTE 1,000.00	Eagleville	School Funds- HS/MS Basketball	HS/MS-JV Basketball Officiating
Robert Smith	NTE 1,000.00	Eagleville	School Funds- HS/MS Basketball	HS/MS-JV Basketball Officiating
Kevin Snell	NTE 1,000.00	Eagleville	School Funds- HS/MS Basketball	HS/MS-JV Basketball Officiating
Austin Bailey	NTE 2,500.00	Eagleville	School Funds- Jr Pro Basketball	Officiating for Jr Pro Basketball at various county schools
Keydon Bassham	NTE 2,500.00	Eagleville	School Funds- Jr Pro Basketball	Officiating for Jr Pro Basketball at various county schools
Phillip Bennett	NTE 2,500.00	Eagleville	School Funds- Jr Pro Basketball	Officiating for Jr Pro Basketball at various county schools
Jim Bingham	NTE 2,500.00	Eagleville	School Funds- Jr Pro Basketball	Officiating for Jr Pro Basketball at various county schools
Ivie Burns	NTE 2,500.00	Eagleville	School Funds- Jr Pro Basketball	Officiating for Jr Pro Basketball at various county schools
James Buttrey	NTE 2,500.00	Eagleville	School Funds- Jr Pro Basketball	Officiating for Jr Pro Basketball at various county schools
Anna Grace Clement	NTE 2,500.00	Eagleville	School Funds- Jr Pro Basketball	Officiating for Jr Pro Basketball at various county schools
Ethan Cobb	NTE 2,500.00	Eagleville	School Funds- Jr Pro Basketball	Officiating for Jr Pro Basketball at various county schools

Rileigh Cobb	NTE 2,500.00	Eagleville	School Funds- Jr Pro Basketball	Officiating for Jr Pro Basketball at various county schools
Carrington Creasy	NTE 2,500.00	Eagleville	School Funds- Jr Pro Basketball	Officiating for Jr Pro Basketball at various county schools
Cameron Curtis	NTE 2,500.00	Eagleville	School Funds- Jr Pro Basketball	Officiating for Jr Pro Basketball at various county schools
Carissa Curtis	NTE 2,500.00	Eagleville	School Funds- Jr Pro Basketball	Officiating for Jr Pro Basketball at various county schools
Brandon Dickerson	NTE 2,500.00	Eagleville	School Funds- Jr Pro Basketball	Officiating for Jr Pro Basketball at various county schools
Christian Edmondson	NTE 2,500.00	Eagleville	School Funds- Jr Pro Basketball	Officiating for Jr Pro Basketball at various county schools
Hayden Edmondson	NTE 2,500.00	Eagleville	School Funds- Jr Pro Basketball	Officiating for Jr Pro Basketball at various county schools
Mike Edmondson	NTE 2,500.00	Eagleville	School Funds- Jr Pro Basketball	Officiating for Jr Pro Basketball at various county schools
Sara Edmondson	NTE 2,500.00	Eagleville	School Funds- Jr Pro Basketball	Officiating for Jr Pro Basketball at various county schools
Trevor Griffin	NTE 2,500.00	Eagleville	School Funds- Jr Pro Basketball	Officiating for Jr Pro Basketball at various county schools
Micah Harris	NTE 2,500.00	Eagleville	School Funds- Jr Pro Basketball	Officiating for Jr Pro Basketball at various county schools
Eric Hawks	NTE 2,500.00	Eagleville	School Funds- Jr Pro Basketball	Officiating for Jr Pro Basketball at various county schools
Colin Henson	NTE 2,500.00	Eagleville	School Funds- Jr Pro Basketball	Officiating for Jr Pro Basketball at various county schools
Tucker Hicks	NTE 2,500.00	Eagleville	School Funds- Jr Pro Basketball	Officiating for Jr Pro Basketball at various county schools
Ty Heoft	NTE 2,500.00	Eagleville	School Funds- Jr Pro Basketball	Officiating for Jr Pro Basketball at various county schools

Brian Hurst	NTE 2,500.00	Eagleville	School Funds- Jr Pro Basketball	Officiating for Jr Pro Basketball at various county schools
Ethan Hurst	NTE 2,500.00	Eagleville	School Funds- Jr Pro Basketball	Officiating for Jr Pro Basketball at various county schools
Bryson Kelley	NTE 2,500.00	Eagleville	School Funds- Jr Pro Basketball	Officiating for Jr Pro Basketball at various county schools
Robert Leathers	NTE 2,500.00	Eagleville	School Funds- Jr Pro Basketball	Officiating for Jr Pro Basketball at various county schools
Blake Lenorad	NTE 2,500.00	Eagleville	School Funds- Jr Pro Basketball	Officiating for Jr Pro Basketball at various county schools
Gregory Logan	NTE 2,500.00	Eagleville	School Funds- Jr Pro Basketball	Officiating for Jr Pro Basketball at various county schools
Niketha Love	NTE 2,500.00	Eagleville	School Funds- Jr Pro Basketball	Officiating for Jr Pro Basketball at various county schools
Mark Wilson Lovinski	NTE 2,500.00	Eagleville	School Funds- Jr Pro Basketball	Officiating for Jr Pro Basketball at various county schools
Mary Elise Lynch	NTE 2,500.00	Eagleville	School Funds- Jr Pro Basketball	Officiating for Jr Pro Basketball at various county schools
Rodney March	NTE 2,500.00	Eagleville	School Funds- Jr Pro Basketball	Officiating for Jr Pro Basketball at various county schools
Ryley McClaran	NTE 2,500.00	Eagleville	School Funds- Jr Pro Basketball	Officiating for Jr Pro Basketball at various county schools
Tim McGehee	NTE 2,500.00	Eagleville	School Funds- Jr Pro Basketball	Officiating for Jr Pro Basketball at various county schools
Hayden McMahon	NTE 2,500.00	Eagleville	School Funds- Jr Pro Basketball	Officiating for Jr Pro Basketball at various county schools
Josh Moates	NTE 2,500.00	Eagleville	School Funds- Jr Pro Basketball	Officiating for Jr Pro Basketball at various county schools
MaKayla Moates	NTE 2,500.00	Eagleville	School Funds- Jr Pro Basketball	Officiating for Jr Pro Basketball at various county schools

Chris Moore	NTE 2,500.00	Eagleville	School Funds- Jr Pro Basketball	Officiating for Jr Pro Basketball at various county schools
CJ Murray	NTE 2,500.00	Eagleville	School Funds- Jr Pro Basketball	Officiating for Jr Pro Basketball at various county schools
Luke Parrish	NTE 2,500.00	Eagleville	School Funds- Jr Pro Basketball	Officiating for Jr Pro Basketball at various county schools
Chris Payne	NTE 2,500.00	Eagleville	School Funds- Jr Pro Basketball	Officiating for Jr Pro Basketball at various county schools
Cody Pepper	NTE 2,500.00	Eagleville	School Funds- Jr Pro Basketball	Officiating for Jr Pro Basketball at various county schools
Calee Pineda	NTE 2,500.00	Eagleville	School Funds- Jr Pro Basketball	Officiating for Jr Pro Basketball at various county schools
Hunter Poff	NTE 2,500.00	Eagleville	School Funds- Jr Pro Basketball	Officiating for Jr Pro Basketball at various county schools
Mark Pope	NTE 2,500.00	Eagleville	School Funds- Jr Pro Basketball	Officiating for Jr Pro Basketball at various county schools
Stefon Porter	NTE 2,500.00	Eagleville	School Funds- Jr Pro Basketball	Officiating for Jr Pro Basketball at various county schools
Jamie Pratt	NTE 2,500.00	Eagleville	School Funds- Jr Pro Basketball	Officiating for Jr Pro Basketball at various county schools
Jesse Pruitt	NTE 2,500.00	Eagleville	School Funds- Jr Pro Basketball	Officiating for Jr Pro Basketball at various county schools
Lucas Pruitt	NTE 2,500.00	Eagleville	School Funds- Jr Pro Basketball	Officiating for Jr Pro Basketball at various county schools
Jacob Rich	NTE 2,500.00	Eagleville	School Funds- Jr Pro Basketball	Officiating for Jr Pro Basketball at various county schools
Tyler Rumley	NTE 2,500.00	Eagleville	School Funds- Jr Pro Basketball	Officiating for Jr Pro Basketball at various county schools
DeVal Smith	NTE 2,500.00	Eagleville	School Funds- Jr Pro Basketball	Officiating for Jr Pro Basketball at various county schools



Fant Smith	NTE 2,500.00	Eagleville	School Funds- Jr Pro Basketball	Officiating for Jr Pro Basketball at various county schools
Jack Smith	NTE 2,500.00	Eagleville	School Funds- Jr Pro Basketball	Officiating for Jr Pro Basketball at various county schools
Bobby Snell	NTE 2,500.00	Eagleville	School Funds- Jr Pro Basketball	Officiating for Jr Pro Basketball at various county schools
Brooklyn Snell	NTE 2,500.00	Eagleville	School Funds- Jr Pro Basketball	Officiating for Jr Pro Basketball at various county schools
Karah Snell	NTE 2,500.00	Eagleville	School Funds- Jr Pro Basketball	Officiating for Jr Pro Basketball at various county schools
Kevin Snell	NTE 2,500.00	Eagleville	School Funds- Jr Pro Basketball	Officiating for Jr Pro Basketball at various county schools
Zach Stevens	NTE 2,500.00	Eagleville	School Funds- Jr Pro Basketball	Officiating for Jr Pro Basketball at various county schools
Elizabeth Thompson	NTE 2,500.00	Eagleville	School Funds- Jr Pro Basketball	Officiating for Jr Pro Basketball at various county schools
Kaley Walker	NTE 2,500.00	Eagleville	School Funds- Jr Pro Basketball	Officiating for Jr Pro Basketball at various county schools
Dylan Watt	NTE 2,500.00	Eagleville	School Funds- Jr Pro Basketball	Officiating for Jr Pro Basketball at various county schools
Sydney Williams	NTE 2,500.00	Eagleville	School Funds- Jr Pro Basketball	Officiating for Jr Pro Basketball at various county schools
Cole Yoders	NTE 2,500.00	Eagleville	School Funds- Jr Pro Basketball	Officiating for Jr Pro Basketball at various county schools
Shayna Housley	NTE 1,500.00	Oakland High	School Funds- Track	Assistant Track and Field Coach
Katherine Atwood	NTE 8,000.00	Riverdale High	Riverdale Band Boosters	Color Guard Instruction
Chad Hewitt	NTE 4,600.00	Riverdale High	Riverdale Softball Boosters	Assistant Softball Coach
Jace May	NTE 4,600.00	Riverdale High	Riverdale Softball Boosters	Assistant Softball Coach

Kyle Etges	NTE 10,000.00	Rockvale High	School Funds-Band	Saxophone Lessons
Marybeth Miller	\$20/Lesson	Rockvale Middle	School Funds-Band	Clarinet Lessons
Stephen Morgan	\$20/Lesson	Rockvale Middle	School Funds-Band	Private Lessons
Kayelie Anguiano	\$23/Practice	Rocky Fork Middle	School Funds-Swimming	Life Guard
Donna Groff	NTE 5,000.00	Siegel High	School Funds-Choir	Piano Accompanist
Jared Nave	NTE 1,000.00	Siegel High	School Funds-Boys Basketball	Assistant Boys Basketball Coach
Trinity Kendrick	\$25.14/Hour	Thurman Francis	School Funds-Swimming	Life Guard
Richard Batey (2)	Hourly	Central Magnet	Clubs, Athletics + Outside Groups	Additional Custodial work for the 2019/2020 school year
Teresa Deno (2)	Hourly	Central Magnet	Clubs, Athletics + Outside Groups	Additional Custodial work for the 2019/2020 school year
Shelly Brewer (2)	Hourly	Rockvale High	Clubs, Athletics + Outside Groups	Additional Custodial work for the 2019/2020 school year
Derrick Foster (2)	Hourly	Rockvale High	Clubs, Athletics + Outside Groups	Additional Custodial work for the 2019/2020 school year
Bob Heath (2)	Hourly	Rockvale High	Clubs, Athletics + Outside Groups	Additional Custodial work for the 2019/2020 school year
Lorraine Lozano (2)	Hourly	Rockvale High	Clubs, Athletics + Outside Groups	Additional Custodial work for the 2019/2020 school year
Wanda McCloud (2)	Hourly	Rockvale High	Clubs, Athletics + Outside Groups	Additional Custodial work for the 2019/2020 school year
Gavin McGoldrick (2)	Hourly	Rockvale High	Clubs, Athletics +	Additional Custodial work for the 2019/2020 school year

			Outside Groups	
Dewayne Reecer (2)	Hourly	Rockvale High	Clubs, Athletics + Outside Groups	Additional Custodial work for the 2019/2020 school year
Tim Stach (2)	Hourly	Rockvale High	Clubs, Athletics + Outside Groups	Additional Custodial work for the 2019/2020 school year

1. Unless listed as an hourly rate
2. Approved previously for an amount \$500 or greater
3. Not less than regular hourly rate – or overtime rate if working over 40 hours during the week
4. Anticipate amounts over \$500 this school year
5. Amend prior approval
6. Less than \$500 but part of event total
7. Pending approval by Transportation Dept.

#### **G. Non-Faculty Volunteer Coaches:**

**According to Tennessee Secondary School Athletic Association (TSSAA) guidelines, Board of Education approval is required to allow non-faculty volunteer coaches to participate in the school athletic programs.**

**The following non-faculty volunteer coaches are for the 2019-2020 school year:**

<b><u>Name</u></b>	<b><u>School</u></b>	<b><u>Sport</u></b>
<b>Kyle Etges</b>	<b>Rockvale High School</b>	<b>Band</b>
<b>Donna Groff</b>	<b>Siegel High School</b>	<b>Choir</b>
<b>David Koger</b>	<b>Siegel High School</b>	<b>Band</b>
<b>Marybeth Miller</b>	<b>Rockvale Middle School</b>	<b>Band</b>
<b>Stephen Mark Morgan</b>	<b>Rockvale Middle School</b>	<b>Band</b>
<b>Elizabeth Gibson</b>	<b>Buchanan Elementary</b>	<b>Archery</b>
<b>Joseph McCaffery</b>	<b>Buchanan Elementary</b>	<b>Archery</b>
<b>Allison Blanton</b>	<b>Central Magnet</b>	<b>Archery</b>
<b>Terence Johnson</b>	<b>Siegel High School</b>	<b>Basketball/Girls</b>
<b>Jared Nave</b>	<b>Siegel High School</b>	<b>Basketball</b>
<b>William Holliday</b>	<b>Whitworth-Buchanan Middle</b>	<b>Basketball/Girls</b>
<b>Chad Hewitt</b>	<b>Riverdale High School</b>	<b>Basketball/Softball</b>
<b>Jace May</b>	<b>Riverdale High School</b>	<b>Softball</b>
<b>Jalyn Brooks</b>	<b>Rockvale High School</b>	<b>Basketball/Girls</b>
<b>Kasey Gregory</b>	<b>Buchanan Elementary</b>	<b>Archery</b>
<b>Shayna Housley</b>	<b>Oakland High School</b>	<b>Track</b>
<b>Heather Dunsford</b>	<b>Thurman Francis</b>	<b>Archery</b>
<b>Casey McClure</b>	<b>Blackman Middle School</b>	<b>Soccer/Boys</b>
<b>Noel Gentry</b>	<b>Riverdale High School</b>	<b>Bowling</b>
<b>Keya Mabiala</b>	<b>Oakland Middle School</b>	<b>Band</b>

**Cameron Phelps  
Youlanda Whitmore  
Kenny Wilson  
Jeromy Barbee  
Lawrence Segree**

**Smyrna High School  
Smyrna Middle School  
Blackman High School  
Blackman High School  
LaVergne High School**

**Tennis  
Basketball/Boys  
Basketball/Boys  
Basketball/Girls  
Track/Football**

Motion made by Mr. Jordan, seconded by Mrs. Johnson, to approve the consent agenda items as presented.

**Vote: All Yes**

**5. VISITORS – No visitors.**

**6. TEXTBOOK SELECTION COMMITTEES FOR ADOPTION OF TEXTBOOKS**

**The names and qualifications of the individuals are being submitted for appointment to the 2019-2020 English Language Arts Instructional Materials Committee upon Board approval. The appropriate forms are included with a document which includes the parents and experts to serve on each respected committee.**

Motion made by Mr. Young, seconded by Mr. Hodge, to approve the individuals submitted to serve on the 2019-2020 English Language Arts Instructional Materials Committees.

**Vote: All Yes**

**7. STEWARTSBORO PTO BOARD-AFFILIATION REQUEST**

**Stewartsboro parents have come together with the school administration to start the process of forming a PTO. The organization has completed the initial steps required and drafted bylaws, and the school administration approves the formation of this organization. The members are dedicated to supporting Stewartsboro teachers, students and staff through fundraising, events and volunteer coordination.**

Motion made by Mr. Jordan, seconded by Mrs. Moore, to approve the formation of the Stewartsboro Elementary School PTO as presented.

**Vote: All Yes**

**8. SPECIAL EDUCATION LIAISON JOB DESCRIPTION UPDATE - FOR INFORMATION ONLY**

**This is an update for the Special Education Liaison job description for the new position, previously board approved. The job description addresses the work for at risk students with disabilities to better align to use of disproportionality funding. This position would be utilized to assist students in Day Treatment and the Juvenile Detention Center by providing instructional support to decrease behavior.**

**9. JOHN COLEMON ANNEX UPDATE**

The Board requested this item be on the next Board agenda.

**10. FACILITIES USE APPROVED FOR EXEMPTION**

Pursuant to Board Policy 3.206 public education schools and institutions, post-secondary education institutions, private universities and colleges, governmental entities or agencies that provide benefits to the Rutherford County School System or have an in-kind relationship approved by the Director of Schools may request the Board of Education to allow an exemption from the use of facilities fee which the Board may allow or deny based upon the details of the specific request.

Motion made by Mrs. Moore, seconded by Ms. Sharp, to approve the following groups requesting fee waivers for the use of facilities to Policy 3.206:

<b>*Cub Scouts Pack 307</b>	<b>Meetings (Wilson ES)</b>
<b>*Girl Scouts</b>	<b>Meetings (Cedar Grove, Rock Springs ES)</b>
<b>Murfreesboro City Schools Basketball</b>	<b>Bradley Academy Home Basketball games (Holloway High)</b>
<b>Rutherford County Conservation Board</b>	<b>Open Gym (Rockvale ES) Jr. Pro Basketball (Rockvale ES, Christiana ES)</b>
<b>Smyrna Jr. Basketball League</b>	<b>Basketball League (Cedar Grove ES)</b>
<b>Stewarts Creek Middle Drama Club</b>	<b>Craft Fair (Stewarts Creek Middle)</b>

**\*Pending submission/approval of MOU**

Note: Facility use for 10/24/19 has been granted pending Board action. A certificate of insurance with \$2,000,000.00 limits (\$1,000,000.00) if approved) is required by each user. Each group must forward any renewals of insurance to the Board on time; otherwise approval is terminated at the end of the policy period. All approvals are for no more than a 1-year period.

**Vote: All Yes**

## **11. FACILITIES**

### **Request to Purchase:**

**The Engineering and Construction Department would like to replace and update the track surface at LaVergne High School in the amount of \$199,934.70. To be purchased from FieldTurf USA, Inc. using OMNIA Partners Contract #R162203. This is an approved project from Capital Project Funds.**

Motion made by Ms. Sharp, seconded by Mrs. Moore, to table this project.

**ROLL CALL VOTE: Yes – Mrs. Moore, Ms. Sharp**

**No - Mrs. Johnson, Mr. Young, Mr. Jordan, Mr. Hodge,  
Mr. Estes**

**Motion Failed.**

Motion made by Mr. Hodge, seconded by Mr. Jordan, to approve the request to replace and update the Track surface at LaVergne High School in the amount of \$199,934.70. To be purchased from FieldTurf USA Inc. using OMNIA Partners Contract #R162203. This is an approved project from Capital Project Funds.

**ROLL CALL VOTE: Yes – Mrs. Johnson, Mr. Young, Mr. Jordan, Mr. Hodge, Mr. Estes**

**No - Mrs. Moore, Ms. Sharp**

**Motion Adopted.**

### **LaVergne High School:**

**LaVergne High School principal Dirk Ash has requested permission to renovate the LHS letters on the hill in front of the school. Engineering and Construction has reviewed the request and finds the letters in disrepair. Mr. Ash has contacted MTSU CIM Department and found local contractors to work with the school at a discounted rate. Cost not to exceed \$13,000.00.**

Motion to approve LaVergne High Schools request to replace the letters on the hill in front of the school, not to exceed \$13,000.00.

**Motion dies due to the lack of a second.**

### **For Information:**

**On September 23, 2019, Mr. Spurlock received a letter from Mayor Ketron to TDOT concerning a federal ADA mandate. On Monday, October 14, Trey Lee met with the County ADA Compliance Officer and Human Resource Director Sonya Stephenson to discuss Rutherford County Schools involvement in the compliance document. We will provide the information required in its entirety, in as timely a manner as possible. The**

document is due December 2019 and they are aware we cannot be complete at this time but will provide a portion of what is required. This program is a 10-year program and the repairs and upgrades that are required will be unfunded.

**12. INSURANCE UPDATE**

**Dr. Anthony reported the next Insurance meeting will be on November 1, 2019.**

**13. Smyrna Professional Development Center**

**Engineering and Purchasing received the bids for the plumbing package for the Professional Development Center renovation on Thursday, October 24, 2019. Two bids were received with Engineering recommending Maynard Select as the lowest and or best bid. Maynard Selects total bid, with the one alternate included is \$40,700.00. These funds are from Capital Projects.**

**Motion made by Mr. Hodge, seconded by Mr. Jordan, to approve Maynard Selects bid for the Plumbing Package #3445 at \$40,700.00.**

**Vote: All Yes**

**14. DIRECTOR'S UPDATE**

**The Director announced that the next Town Hall Meeting is Monday, October 28 at 5:30 P.M. at Rockvale Hight School.**

**15. TENNESSEE LEGISLATIVE NETWORK (TLN) UPDATE – No report at the present time.**

**16. FEDERAL RELATIONS NETWORK (FRN) UPDATE – No report at the present time.**

**There being no further business, the meeting adjourned at approximately 5:45 P.M.**

---

**Jim Estes**

---

**Date**

---

**Bill C. Spurlock, Director of Schools**

---

**Date**





## FACILITIES USE

November 12, 2019

## CONSENT AGENDA

Oakland High	Super F League, indoor soccer, 11/12/19-3/21/20 Fr-Su 5-10pm, Indoor facility, \$105/hr
Oakland Middle	The Dance Academy, dance recital, 6/11/20-6/13/20 7:30am-9pm, 2 backstage rooms and auditorium, \$945
Oakland Middle	Dance Classics, year-end recital, 5/22/20-5/23/20 Fri 3:30-9:30pm Sat 8am-9pm, choir room & auditorium, \$600
Rock Springs Elementary	Universal Sports League of LaVergne, basketball practice and games, 12/2/19-3/14/20 M-F 6-9:30pm Sa 8am-6pm Su 5-8pm, gym, \$2556
Rockvale Middle	Rockvale Meadows HOA, HOA annual meeting, 12/3/19 6:30-8:30pm, cafeteria, \$18/hr
Rockvale Middle	Blue Ribbon Estates HOA, HOA annual meeting, 11/14/19 6:30-8:30pm, cafeteria, \$18/hr
Siegel High	Stars Wrestling Club, AAU team wrestling practices, 11/12/19-11/12/20 M-F 5:30-7:45pm, cafeteria, \$18/hr
Smyrna High	Christina's Dance Center, Christmas recital, 12/15/19 9am-6pm, choir room and auditorium, \$300
Stewarts Creek High	Blueprint Baseball, practice, 11/12/19-11/12/20 Saturdays 1-4pm, baseball field, \$18/hr

Note: Facility use for 11/12/19 has been granted pending Board action. A certificate of insurance with \$2,000,000.00 limits (\$1,000,000.00 if approved) is required by each user. Each group must forward any renewals of insurance to the Board on time; otherwise approval is terminated at the end of the policy period. **All approvals are for no more than a 1-year period.**

## Transportation

Pursuant to Section 16.1 of the Rutherford County Board of Education Bus Contract, the transportation dept. has received a letter dated 10/31/2019 from MaryAnn Gregory, contractor of bus #261, requesting voluntary termination of her contract with the Board. The transportation dept. is prepared to award this contract to the next potential contractor on the appropriate contractor list.

Recommend Approval – motion to approve voluntary termination of the Bus Contract from MaryAnn Gregory, bus #261, effective as soon as possible.

## **Julie Taylor with A+ Literacy Consulting Agreement:**

Julie Taylor will provide three days of support in Guided Reading to the staff at LaVergne Lake Elementary:

Julie Taylor will provide 3 days of training where she will both model and assist teachers in planning of guided reading lessons in grades K-5. The goal of this training is to instruct teachers how to effectively create and instruct guided reading lessons.

The total cost for the training day is \$5,250.00 for the presenter. LaVergne Lake Title I funds will pay for 100% of the cost.

**Motion to approve,** a contract between A+ Literacy Consulting and the Rutherford County Schools for 3 days of teacher training.

**MEMORANDUM OF AGREEMENT BETWEEN  
LAVERGNE LAKE ELEMENTARY SCHOOL AND  
Julie A. Taylor**

WHEREAS, Julie A. Taylor seeks to provide guided reading support at Lavergne Lake Elementary School.

WHEREAS, Lavergne Lake Elementary School would directly benefit from Ms. Taylor's expertise;

THEREFORE, in consideration of the mutual benefit to the parties, Lavergne Lake Elementary School and Ms. Taylor agree as follows:

1. Julie A. Taylor will ensure that she complies with all rules and regulations of Lavergne Lake Elementary School and Rutherford County Schools, as well as all applicable federal, state, and local laws, statutes, ordinances, rules and regulations while observing in the classroom, including, but not limited to, the Family Educational Rights and Privacy Act of 1974 (FERPA). Violation of any rule, regulation, policy, procedure, or law may result in the termination of this agreement, and a discontinued allowance of observations at other Rutherford County Schools.
2. Ms. Taylor agrees is to be compensated pursuant to the attached invoice provided by Ms. Taylor.
3. Neither party shall assign this Agreement or enter into subcontracts for any of the work described herein without obtaining the prior written approval of the other party.
4. This Agreement may be modified only by a written amendment executed by all parties hereto and approved by the appropriate officials.
5. Both Parties hereby agree, warrant, and assure that no person shall be excluded from participation in, be denied benefits of, or be otherwise subjected to discrimination in the performance of this Agreement or in the employment practices of either Party on the grounds of disability, age, race, color, religion, sex, veteran status, national origin, or any other classification protected by Federal, or State constitutional or statutory law. Both Parties shall, upon request, show proof of such nondiscrimination and shall post in conspicuous places, available to all employees and applicants, notices of nondiscrimination.
6. This Agreement shall be governed by and construed in accordance with the laws of the State of Tennessee. The venue and jurisdiction for the resolution of any such disputes shall be in the State or Federal courts located in the state of Tennessee.

7. The District is a political subdivision of the State of Tennessee and, as such, its liability for injuries which may result from its performance under this Agreement shall be subject to and limited to those rights and remedies, if any, available under the Tennessee Governmental Tort Liability Act, T.C.A. §§ 29-20-201, et seq. Each party shall be solely liable for payment of its portion of all claims, liability, costs, expenses, demands, settlements, or judgments resulting from action or omissions of itself or those for whom it is legally responsible, relating to or arising under this Agreement.
8. The term of this Memorandum of Agreement shall terminate on May 29, 2020.
9. This Agreement represents the entire Agreement with respect to the subject matter herein.

In Witness Whereof, the duly authorized officers of the parties hereto have executed this Memorandum of Agreement.

\_\_\_\_\_  
Signature of RCS Representative

\_\_\_\_\_  
Date

*Julie A. Taylor*

\_\_\_\_\_  
Signature of Julie A. Taylor

\_\_\_\_\_  
10/01/19

\_\_\_\_\_  
Date

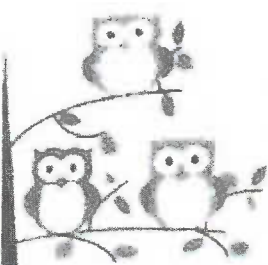

### A+ Literacy Consulting Training Quote

District/School Name: LaVergne Lake Elementary School

Address: 201 Davids Way

City, State, Zip: LaVergne, TN 37086

Contact Person: Anna Sturm

Phone: [sturma@rcshools.net](mailto:sturma@rcshools.net)

Follow-Up PD and Support: Assessments, Grouping, Model Lessons			
Date	Hours	Services	Cost per Day
12/16/19	Contracted School Hours	Kindergarten	\$1,750.
		Grade 1	
12/17/19	Contracted School Hours	Grade 2	\$1,750.
		Grade 3	
12/18/19	Contracted School Hours	Grade 4	\$1,750.
		Grade 5	
Total			\$5,250.

*Please pay invoice within 10 days  
after Training/PD is delivered*

*Check Can Be Made Payable to:*

**A+ Literacy Consulting, LLC**

3444 Fox Hunt Drive

Palm Harbor, FL 34683

(727) 307-8630

EIN # 47-5561879

**Additional Notes:**

Total Cost is all-inclusive: I arrange and pay all costs  
for travel, flight, car rental, hotel, and meals.

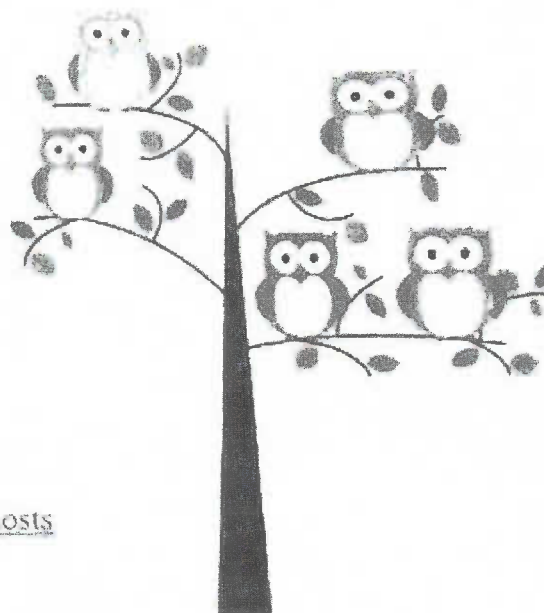

**Bid #3444**  
**Washington, DC Trip**  
**Thurman Francis Arts Academy**  
**(May 11, 2020 - May 15, 2020)**

All About Group Travel		Bob Rogers Travel		Educational Travel Consultants		Green Light Group Tours		Martin Tours		Thomas Tours	
55-65 paying passengers	\$ 825.00	70-79 paying passengers	\$ 799.00	50-59 paying passengers	\$ 749.00	55-64 paying passengers	\$ 897.00	55-70 + paying passengers	\$ 669.00	55-69 paying passengers	\$ 840.00
66-70 paying passengers	\$ 705.00	80-90 paying passengers	\$ 729.00	60-69 paying passengers	\$ 899.00	65-69 paying passengers	\$ 826.00			70+ paying passengers	\$ 750.00
71-80 paying passengers	\$ 699.00			70-79 paying passengers	\$ 839.00	70-74 paying passengers	\$ 798.00				

Mailed to 15 vendors  
9 vendors did not respond

Recommend: Motion to award to Martin Tours for overall lowest and best bid.

To be funded through Thurman Francis School.

Educational Epiphany, LLC Agreement:

Dr. Donyall Dickey will present one training to the district instructional coaches:

1. Dr. Donyall Dickey will present a workshop, team planning and deconstructing standards on Dec 9<sup>th</sup>, 2019. This training follows District Goal 3: increasing achievement scores and reaching AMO targets and Goal 4: training effective teachers and district instructional leaders. Instructional coaches will disperse training into each of their schools.

The total cost for the training day is \$5,500 for the presenter. Title II funds will pay for 100% of the cost.

**Motion to approve**, a contract between Educational Epiphany, LLC. and the Rutherford County Schools for the following teacher training workshop.





# INVOICE

Estimate for Rutherford County Schools

**Educational Epiphany, LLC**  
1750 Pennsylvania Avenue #27066  
Washington, District of Columbia 20038  
United States

(410) 258-6443  
www.educationalepiphany.com

## BILL TO

**Rutherford County Schools**  
Jimmy Sullivan

SullivanJA@rcschools.net

**Invoice Number:** 5208

**P.O./S.O. Number:** Please submit

**Invoice Date:** November 1, 2019

**Payment Due:** December 1, 2019

**Amount Due (USD):** \$5,500.00

Items	Quantity	Price	Amount
<b>School District Speaking/PD Session</b> Professional Development and Team Planning With Dr. Donyall Dickey December 9, 2019	1	\$5,500.00	\$5,500.00

**Total:** \$5,500.00

**Amount Due (USD):** \$5,500.00

## Notes

Mr. Sullivan,

Thank you for choosing Educational Epiphany, LLC for your professional development needs.

Emily

Thank you for your business!

**MEMORANDUM OF AGREEMENT BETWEEN  
Rutherford County Schools and Educational Epiphany, LLC**

WHEREAS, Educational Epiphany seeks to provide a speaker, Dr. Donyall Dickey on Dec. 9<sup>th</sup>, 2019 at Blackman Elementary School for Instructional Coaches

WHEREAS, Rutherford County Schools would directly benefit from Dr. Donyall Dickey's expertise;

THEREFORE, in consideration of the mutual benefit to the parties, Rutherford County Schools and Educational Epiphany, LLC agree as follows:

1. Dr. Donyall Dickey will ensure that he complies with all rules and regulations of Rutherford County Schools, as well as all applicable federal, state, and local laws, statutes, ordinances, rules and regulations while observing in the classroom, including, but not limited to, the Family Educational Rights and Privacy Act of 1974 (FERPA). Violation of any rule, regulation, policy, procedure, or law may result in the termination of this agreement, and a discontinued allowance of observations at other Rutherford County Schools.
2. Educational Epiphany, LLC agrees is to be compensated pursuant to the attached invoice provided by Educational Epiphany, LLC
3. Neither party shall assign this Agreement or enter into subcontracts for any of the work described herein without obtaining the prior written approval of the other party.
4. This Agreement may be modified only by a written amendment executed by all parties hereto and approved by the appropriate officials.
5. Both Parties hereby agree, warrant, and assure that no person shall be excluded from participation in, be denied benefits of, or be otherwise subjected to discrimination in the performance of this Agreement or in the employment practices of either Party on the grounds of disability, age, race, color, religion, sex, veteran status, national origin, or any other classification protected by Federal, or State constitutional or statutory law. Both Parties shall, upon request, show proof of such nondiscrimination and shall post in conspicuous places, available to all employees and applicants, notices of nondiscrimination.
6. This Agreement shall be governed by and construed in accordance with the laws of the State of Tennessee. The venue and jurisdiction for the resolution of any such disputes shall be in the State or Federal courts located in the state of Tennessee.

7. The District is a political subdivision of the State of Tennessee and, as such, its liability for injuries which may result from its performance under this Agreement shall be subject to and limited to those rights and remedies, if any, available under the Tennessee Governmental Tort Liability Act, T.C.A. §§ 29-20-201, et seq. Each party shall be solely liable for payment of its portion of all claims, liability, costs, expenses, demands, settlements, or judgments resulting from action or omissions of itself or those for whom it is legally responsible, relating to or arising under this Agreement.
8. The term of this Memorandum of Agreement shall terminate on May 29, 2020.
9. This Agreement represents the entire Agreement with respect to the subject matter herein.

In Witness Whereof, the duly authorized officers of the parties hereto have executed this Memorandum of Agreement.

\_\_\_\_\_  
Signature of RCS Representative

\_\_\_\_\_  
Date

*Dr. Donyall Dickey*  
\_\_\_\_\_  
Signature for Educational Epiphany, LLC. Date  
(Dr. Donyall Dickey, CEO)

*11/5/15*  
\_\_\_\_\_  
*OPW*

## LEASE AGREEMENT

This Lease is made and effective the 1<sup>st</sup> day of August, 2017 by and among Rutherford County Board of Education, (hereinafter referred to as "Lessor") whose address for all purposes under this Lease shall be 2240 Southpark Blvd, Murfreesboro, TN 37128 and Mid-Cumberland Community Action Agency, Inc., (hereinafter referred to as "Lessee"), whose address is Mid-Cumberland CAA, PO Box 1583, Murfreesboro, TN 37133-1583. 310, Lebanon, TN 37088-0310. Mid-Cumberland Community Action Agency

(m 22)  
8/24/17  
8/24/17  
1250

1. **DESCRIPTION OF PREMISES.** The Lessor does hereby lease unto the Lessee a portion of the old building at John Coleman Elementary School as generally shown on Exhibit "A". The Leased Premises shall consist of "B-Hall" and the classrooms on "B-Hall" ("Leased Premises"). In addition to the Leased Premises, the Lessee shall have the non-exclusive right to use the hallway marked "Hallway", the two restrooms and laundry room on "A-Hall" which are circled on the attached Exhibit "A", and fifteen (15) parking spaces in the parking lot ("Common Area").

### 2. **TERM**

(a) The term of this Lease shall begin on August 1, 2017 and run until July 31, 2037. This Lease shall automatically renew for terms of one year each upon the expiration of the then current term unless Lessor or Lessee terminates this Lease as provided herein below. Notwithstanding the above, Lessor or Lessee shall have the right to terminate this lease at any time by giving the other party a minimum of ninety (90) days advance written notice of the intent to terminate.

3. **RENT.** The rent shall be One Hundred and 00/100 Dollars (\$100.00) per year.

4. **UTILITIES AND REPAIRS.** Lessee shall be responsible for a pro-rata portion of the utilities based on the square footage of the leased area compared to the John Coleman Elementary School building as a whole. Lessee shall be responsible for the maintenance of the Leased Premises during the lease term, and for any damages caused to the Common Area, if any.

5. **TAXES AND ASSESSMENTS.** If any, Lessee shall be responsible to pay any taxes charged on Lessee's portion of the property located on the Leased Premises. Lessor shall pay all the city and county real estate taxes assessed during the term of this lease agreement on the Leased Premises. Any ad valorem taxes on personal property owned by the Lessee shall be paid by the Lessee when due.

6. **USE OF PREMISES.** Lessee shall only use the Leased Premises in a careful and proper manner and shall comply with all laws, rules, ordinances, statutes, zoning and orders regarding the use, operation and maintenance of the Premises.

7. **ENCUMBRANCES.** Lessee may not encumber by mortgage, deed of trust, or other instrument its leasehold interest in the Leased Premises.

8. **SIGNAGE.** Any signage of Lessee must comply with all sign ordinances and be approved by Lessor prior to being installed.

9. **NOTICES.** All notices, demands, or other writings in this lease to be given, made, or sent, or which may be given, made, or sent by either party hereto to the other, shall be deemed to have been fully given, made, or sent when made in writing and deposited in the United States mail, registered or certified, postage prepaid, overnight carrier, or hand-delivery addressed to the following addresses:

To Lessor: Rutherford County Board of Education  
Attn: Director of Schools  
2240 Southpark Blvd.  
Murfreesboro, Tennessee 37128  
Email: odomd@rcschools.net  
Phone Contact: 615-893-5182

To Lessee: Mid-Cumberland Community Action Agency, Inc.  
Head Start Office  
P. O. Box 1583 310  
Murfreesboro, TN 37133-1583 Lebanon, TN 37088-0010  
Email: Sbatten@mcheadstart.org or Jogles@mcheadstart.org or mburroughs@midcumberland.org  
Phone Contact: 615-893-6614 ext. 1026 or ext. 1028  
615-742-1113 ext. 2020

1257 MPD 8/28/17  
8/28/17 MPD 8/28/17  
8/28/17 MPD 8/28/17

The address to which any notice, demand, or other writing may be given may be changed by written notice given by such party as above provided.

10. **INDEMNIFICATION OF LESSOR.** Lessor shall not be liable for any claim, loss, injury, death, or damage to persons or property occurring in regard to the Leased Premises, Common Area, and/or Lessor's use of the property during the term of this Lease. Lessee shall indemnify and hold Lessor harmless against all claims, liability, loss, or damage whatsoever occurring on or in regards to the same. Lessee hereby waives all claims against Lessor for damages to the Leased Premises, Common Area and improvements that are now on or hereafter placed or built on the Leased Premises or Common Area and to the property of Lessee in, on, or about the Leased Premises and/or Common Area, from any cause arising at any time.

11. **REDELIVERY OF PREMISES.** Lessee shall pay all sums required to be paid by Lessee hereunder in the amounts, at the time, and in the manner herein provided, and shall keep and perform all terms and conditions hereof on its part to be kept and performed, and at the expiration or sooner termination of this lease, Lessee shall peaceably and quietly quit and surrender the Leased Premises to Lessor in good order and condition subject to the other provisions of this lease.

12. **REMEDIES OF DEFAULT.** In the event of a default hereunder, Lessor shall have the following rights which shall be cumulative: a) Lessor shall have the right to enter the Leased Premises and Common Area and take possession thereof, and the rent shall become due thereupon and be paid up to the time of re-

entry, (b) Lessor may relet the property or any part or parts thereof, either in the name of Lessor or otherwise, for a term or terms which may, at Lessor's option, be less than or exceed the period which would otherwise have constituted the balance of the term of this lease, and (c) Lessee shall also pay to the Lessor as damages for the failure of Lessee to observe and perform Lessee's covenants herein contained any deficiency between the rent hereby reserved and/or agreed to be paid and the net amount, if any, from the rents collected for the Leased Premises, if released, for the balance of the term of this agreement. In computing such damages, there shall be added to the said deficiency such reasonable expenses as Lessor may incur in connection with reletting, such as brokerage fees and preparation for reletting. Lessor agrees to make a good faith effort to mitigate all damages and to relet the property in the event of any default specified herein. In addition to the aforesaid damages, Lessor shall have all other remedies afforded by law not in conflict herewith, and all security deposits shall be forfeited to Lessor. In addition to any other remedies to which Lessor is entitled, Lessor shall be entitled to recover Lessor's attorney's fees and court costs incurred to enforce this Lease.

**13. EFFECT OF LESSEE'S HOLDING OVER.** Any holding over after the expiration of the term of this lease, without written consent of Lessor, shall be an act of default and shall also be construed to be a tenancy at will.

**14. ROUTINE MAINTENANCE.** Lessee shall solely responsible for keeping the Leased Premises in good order, clean, and maintained during the term of the Lease, and shall deliver the Leased Premises to Lessor upon termination of the lease in good condition. Lessor shall be responsible for maintenance of roofing & HVAC systems. Lessee is solely responsible for maintaining the landscaping around the Premises, including but not limited to mowing the Premises. Lessee shall be responsible, at Lessee's sole expense, to clean up and remove any chemical or other hazardous materials placed on the Leased Premises by Lessee, Lessee's employees, agents, principals, invitees or subcontractors. Lessee shall be responsible for any damage to the property caused by Lessee or Lessee's guest, invitees, or agents.

**15. WARRANTIES.** Lessors make no warranties concerning the structure, quality or safety of the Leased Premises. Lessee accepts the Leased Premises "AS IS" with no warranties or representations, either expressed or implied.

**16. INSURANCE.** The Lessee covenants and agrees to purchase a comprehensive public liability insurance policy to protect and insure the Lessee from any and all claims for any personal injury or death or any and all claims of any type of nature which might arise from the Lessee's use and occupation of the Leased Premises, Common Area, and property during the term of this Lease. Said liability insurance policy shall be in a minimum amount of One Million and 00/100 Dollars (\$1,000,000.00) per person for any accident, injury, death, or claim of any type or nature to any person on the Leased Premises and Common Area during the term of this Lease and be issued by an insurance carrier acceptable to Lessor. Said policy shall name Lessor as an additional insured thereunder. The Lessee shall furnish the Lessor a copy of documents evidencing such insurance coverage upon execution of this Lease and at such further times requested by Lessor. Lessee shall be responsible to maintain property and casualty insurance on Lessee's personal property and all contents of the Leased Premises. LESSOR SHALL NOT INSURE LESSEE'S PERSONAL PROPERTY AND LESSEE IS ADVISED TO OBTAIN INSURANCE FOR THE SAME.

17. **ASSIGNMENT AND SUBLETTING BY LESSEE.** Lessee may not assign this Lease or sublet the Leased Premises or Common Area with the prior written consent of the Lessor.

18. **TIME OF THE ESSENCE.** Time is of the essence of this lease, and of each and every covenant, term, condition, and provision hereof.

19. **SEVERABILITY.** If any part or parts of this agreement shall be held unenforceable for any reason, the remainder of this Lease Agreement shall continue in full force and effect. If any provision of this Lease Agreement is deemed invalid or unenforceable by any court of competent jurisdiction, and if limiting such provision would make the provision valid, then such provision shall be deemed to be construed as so limited.

20. **WAIVER.** The failure of either party to enforce any provisions of this Lease Agreement shall not be deemed a waiver of limitation of that party's right to subsequently enforce and compel strict compliance with every provision of this Lease Agreement. The acceptance of rent by Lessor does not waive Lessor's right to enforce any provisions of this Agreement.

IN WITNESS WHEREOF, the Lessor and the Lessee have respectively executed this Lease as of, and from that, date first written above.

"LESSOR"

RUTHERFORD COUNTY

BOARD OF EDUCATION

By: Martin D. Odum

Title: Director

"LESSEE"

MID-CUMBERLAND COMMUNITY

ACTION AGENCY, INC.

By: Kevin S. Davenport + K.S. Dap +

Title: Executive Director

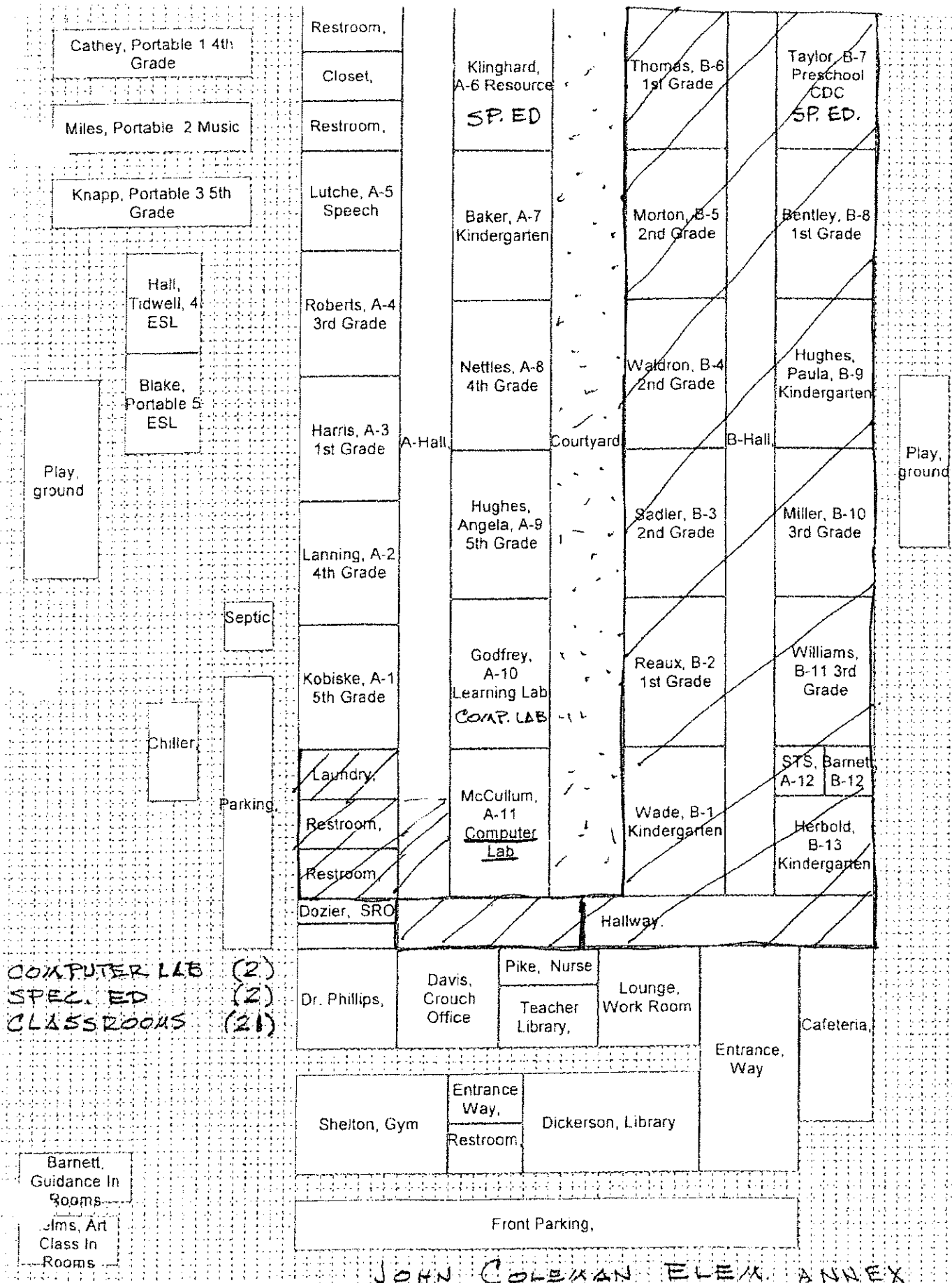

JOHN COLEMAN ELEMENTARY ANNEX  
"EXHIBIT A"



Rutherford County School Nutrition						
Outstanding Credit Balance For Meals						
As of November 1, 2019						
SCHOOLS	STUDENTS	ADULTS	# of Students that owe	Avg owed by student	# of Adults that owe	Free and Reduced %
Barfield School	\$1,650.93	\$24.60	129	\$12.80	7	28.33%
Blackman Elementary	\$1,741.21	\$50.25	125	\$13.93	10	28.29%
Blackman High School	\$2,694.61	\$28.50	224	\$12.03	3	21.65%
Blackman Middle School	\$5,159.37	\$82.95	278	\$18.56	8	27.60%
Brown's Chapel Elem.	\$1,891.07	\$146.85	103	\$18.36	14	30.83%
Central Magnet School	\$451.11	\$69.00	92	\$4.90	10	7.93%
Cedar Grove Elementary	\$2,760.77	\$2.00	197	\$14.01	8	69.63%
Christiana Elementary	\$1,553.24	\$5.00	105	\$14.79	3	24.46%
Christiana Middle School	\$2,974.46	\$35.48	170	\$17.50	7	27.66%
Daniel McKee	\$188.47	\$44.25	26	\$7.25	5	67.53%
David Youree	\$5,447.23	\$122.75	166	\$32.81	11	66.89%
Eagleville School	\$526.04	\$197.40	111	\$4.74	17	19.62%
Holloway	\$433.00	29.75	36	\$12.03	5	54.70%
HP Campus	\$141.73	\$0.00	32	\$4.43	0	4.66%
John Buchanan Elementary	\$1,316.14	\$279.05	112	\$11.75	22	33.27%
John Coleman	\$1,201.44	\$96.50	75	\$16.02	8	68.35%
Kittrell Elementary	\$395.74	\$13.09	41	\$9.65	4	62.31%
Lascassas Elementary	\$1,647.56	\$1.25	83	\$19.85	1	17.93%
LaVergne Lake Elem.	\$5,215.35	\$199.00	223	\$23.39	21	65.96%
LaVergne High	\$6,403.24	\$0.00	409	\$15.66	0	59.94%
LaVergne Middle	\$8,626.60	\$167.75	296	\$29.14	17	70.22%
LaVergne Primary	\$2,111.55	\$140.50	118	\$17.89	14	64.54%
McFadden	\$233.70	\$16.75	34	\$6.87	4	4.62%
Oakland High	\$6,624.71	\$23.85	312	\$21.23	7	32.62%
Oakland Middle	\$4,393.10	\$146.75	210	\$20.92	11	38.34%
Riverdale High	\$8,816.64	\$6.50	372	\$23.70	1	33.61%
Rock Springs Elementary	\$5,113.32	\$164.60	213	\$24.01	18	42.65%
Rock Springs Middle	\$3,694.24	\$54.50	195	\$18.94	8	51.94%
Rockvale Elementary	\$1,616.89	\$0.00	135	\$11.98	0	20.17%
Rockvale High	\$6,263.64	\$88.25	297	\$21.09	8	29.34%
Rockvale Middle	\$5,193.84	\$53.75	261	\$19.90	10	29.57%
Rocky Fork Elementary	\$4,433.43	\$150.25	191	\$23.21	13	47.53%
Rocky Fork Middle	\$5,771.99	\$101.50	183	\$31.54	13	53.88%
Roy Waldron	\$7,440.75	\$152.85	196	\$37.96	12	71.52%
Siegel High School	\$2,536.75	\$1.25	150	\$16.91	1	26.99%
Siegel Middle School	\$2,846.97	\$61.75	180	\$15.82	12	26.06%
Smyrna Elementary	\$3,084.90	\$204.90	144	\$21.42	18	73.90%
Smyrna High	\$4,135.50	\$3.50	306	\$13.51	1	50.34%
Smyrna Middle	\$9,189.26	\$186.20	275	\$33.42	13	64.85%
Smyrna Primary	\$2,997.27	\$258.50	147	\$20.39	24	60.83%
Smyrna West	\$833.70	\$3.00	37	\$22.53	7	69.61%
Stewartsboro	\$2,341.87	\$115.05	132	\$17.74	18	49.42%
Stewarts Creek Elementary	\$933.22	\$188.85	136	\$6.86	16	26.08%
Stewarts Creek High	\$4,031.36	\$23.75	225	\$17.92	4	25.38%
Stewarts Creek Middle	\$518.17	\$109.25	96	\$5.40	10	28.54%
Thurman Francis	\$273.81	\$10.25	61	\$4.49	3	14.47%
Walter Hill	\$594.70	\$88.00	60	\$9.91	10	41.75%
Whitworth Buchanan Middle	\$6,199.06	\$177.00	195	\$31.79	17	57.52%
Wilson Elementary	\$1,416.44	\$137.75	139	\$10.19	18	24.72%
<b>TOTAL:</b>	<b>\$156,060.09</b>	<b>\$4,264.47</b>	<b>8033</b>		<b>472</b>	

<b>Charge Trend for Last Three School Years</b>						
<b>Balance at End of School Year 16-17- May</b>	<b>FY 16-17- BOE Paid Bad Debt Meal Charges</b>					
<b>\$82,375.23</b>	<b>\$45,998.43</b>					
<b>Balance at End of School Year 17-18- May</b>	<b>FY 16-17- BOE Paid Bad Debt Meal Charges</b>					
<b>\$119,323.95</b>	<b>\$89,323.00</b>					
<b>Balance at End of School Year 18-19- May</b>	<b>FY 16-17- BOE Paid Bad Debt Meal Charges</b>					
<b>\$179,815.25</b>	<b>\$111,527.69</b>					

Rutherford County School Nutrition		
Outstanding Credit Balance For Meals		
As of September 30, 2019		
SCHOOLS	STUDENTS	ADULTS
Barfield School	\$1,128.26	\$4.00
Blackman Elementary	\$1,800.67	\$27.00
Blackman High School	\$1,890.50	\$7.00
Blackman Middle School	\$3,725.03	\$44.45
Brown's Chapel Elem.	\$1,627.36	\$69.40
Central Magnet School	\$483.39	\$27.00
Cedar Grove Elementary	\$2,519.86	\$0.00
Christiana Elementary	\$1,284.64	\$25.55
Christiana Middle School	\$2,230.70	\$59.00
Daniel McKee	\$198.25	\$44.25
David Youree	\$3,598.12	\$72.50
Eagleville School	\$389.55	\$75.30
Holloway	\$405.80	20.75
HP Campus	\$35.08	\$0.00
John Buchanan Elementary	\$1,000.09	\$185.95
John Coleman	\$995.65	\$46.75
Kittrell Elementary	\$310.79	\$14.74
Lascassas Elementary	\$1,471.07	\$12.25
LaVergne Lake Elem.	\$4,317.38	\$168.50
LaVergne High	\$5,110.77	\$0.00
LaVergne Middle	\$6,636.46	\$174.50
LaVergne Primary	\$1,439.80	\$93.50
McFadden	\$151.30	\$10.00
Oakland High	\$4,336.58	\$24.10
Oakland Middle	\$4,217.54	\$88.00
Riverdale High	\$6,471.02	\$0.75
Rock Springs Elementary	\$4,303.14	\$158.15
Rock Springs Middle	\$2,416.62	\$85.25
Rockvale Elementary	\$1,578.03	\$16.40
Rockvale High	\$4,653.98	\$36.50
Rockvale Middle	\$4,155.49	\$27.00
Rocky Fork Elementary	\$3,787.71	\$113.50
Rocky Fork Middle	\$4,498.27	\$122.00
Roy Waldron	\$4,604.72	\$60.60
Siegel High School	\$2,178.25	\$4.75
Siegel Middle School	\$2,319.38	\$32.75
Smyrna Elementary	\$2,486.03	\$118.25
Smyrna High	\$3,006.01	\$0.50
Smyrna Middle	\$5,910.64	\$95.20
Smyrna Primary	\$2,763.10	\$291.92
Smyrna West	\$384.17	\$23.00
Stewartsboro	\$1,733.50	\$51.55
Stewarts Creek Elementary	\$720.23	\$73.35
Stewarts Creek High	\$3,351.80	\$25.75
Stewarts Creek Middle	\$448.98	\$92.90
Thurman Francis	\$280.74	\$17.00
Walter Hill	\$107.50	\$69.35
Whitworth Buchanan Middle	\$4,418.74	\$175.49
Wilson Elementary	\$1,074.26	\$56.00
<b>TOTAL:</b>	<b>\$118,956.95</b>	<b>\$3,042.40</b>

Rutherford County School Nutrition		
Outstanding Credit Balance For Meals		
As of August 31, 2019		
SCHOOLS	STUDENTS	ADULTS
Barfield School	\$620.26	\$32.25
Blackman Elementary	\$1,830.10	\$100.00
Blackman High School	\$1,018.21	0
Blackman Middle School	\$2,041.35	\$8.00
Brown's Chapel Elem.	\$1,092.93	\$36.50
Central Magnet School	\$505.78	\$27.50
Cedar Grove Elementary	\$1,879.97	
Christiana Elementary	\$840.26	\$7.00
Christiana Middle School	\$1,145.15	\$7.00
Daniel McKee	\$12.00	\$47.40
David Youree	\$1,548.06	\$64.25
Eagleville School	\$354.01	\$58.70
Holloway	\$321.30	0
HP Campus	\$205.23	\$10.25
John Buchanan Elementary	\$702.43	\$146.50
John Coleman	\$1,328.19	\$62.50
Kittrell Elementary	\$406.08	\$26.99
Lascassas Elementary	\$765.59	\$10.50
LaVergne Lake Elem.	\$2,465.77	\$140.75
LaVergne High	\$2,405.81	0
LaVergne Middle	\$3,221.09	\$109.20
LaVergne Primary	\$904.10	\$39.80
McFadden	\$244.65	\$50.15
Oakland High	\$2,324.74	\$27.75
Oakland Middle	\$2,085.00	\$75.50
Riverdale High	\$2,756.15	0
Rock Springs Elementary	\$3,208.27	\$87.40
Rock Springs Middle	\$1,216.53	\$62.00
Rockvale Elementary	\$1,105.23	\$31.65
Rockvale High	\$2,398.73	\$15.75
Rockvale Middle	\$2,365.36	\$23.50
Rocky Fork Elementary	\$1,727.17	\$46.75
Rocky Fork Middle	\$1,744.37	\$48.25
Roy Waldron	\$2,591.10	\$67.00
Siegel High School	\$928.40	0
Siegel Middle School	\$1,282.17	\$124.29
Smyrna Elementary	\$763.45	\$55.75
Smyrna High	\$1,601.08	\$3.50
Smyrna Middle	\$2,392.55	\$66.25
Smyrna Primary	\$1,625.49	\$98.75
Smyrna West	\$153.90	\$34.75
Stewartsboro	\$1,026.09	\$47.50
Stewarts Creek Elementary	\$706.28	\$104.75
Stewarts Creek High	\$1,605.30	\$8.00
Stewarts Creek Middle	\$336.80	\$38.75
Thurman Francis	\$249.40	\$6.50
Walter Hill	\$290.19	\$148.03
Whitworth Buchanan Middle	\$2,594.26	\$100.15
Wilson Elementary	\$689.73	\$100.45
<b>TOTAL:</b>	<b>\$65,626.06</b>	<b>\$2,408.21</b>

## Rutherford County Schools

### Application for Campus Construction Project

Before any request for construction of proposed buildings will be forwarded to the Rutherford County School Board, the following form must be filled out in full and submitted to the Rutherford County Schools Engineering and Construction Department with a letter from the School Principal, a site plan, floor plan and elevations (if applicable), a full estimate, and schedule.

1. School Name  
BLACKMAN MIDDLE SCHOOL
2. Principal  
DR. AMY CONNIFEN-MARLIN
3. Project Name  
SOFTBALL BLEACHER CONCRETE SLABS
4. Assistant Principal who is overseeing the project  
JUSTIN USERY
5. Does project support recreational sports, athletics or education?  
YES
6. Does this project meet all gender equity criteria?  
YES
7. What department is this project being constructed for? (I.E. Baseball, softball, band, FFA, etc.)  
SOFTBALL
8. What is the anticipated cost for this project (this should include all utility connection fees, building permits, inspection, and construction). Attach and submit a detailed estimate.
9. What is the funding source and are funds currently available: (Grant, Booster Club, etc.) List all sources.  
CONCRETE DONATED + LABOR IS PAID BY FUNDRAISERS
10. If a grant or funded by a foundation/donor/ charitable organization, what is the foundations name?  
CONCRETE DONATED BY SMYRNA READY MIX  
Do construction plans meet criteria for funding?  
N/A
11. If funded by a local financial institution, has the loan been approved and who is the guarantor for loan  
N/A
12. Do you have a site layout showing where this project will be constructed on campus?  
YES, ATTACHED
13. Has RCS Engineering & Construction reviewed project location? Are there any conflicts in utilities or easements?
14. Has MTEMC, CUD, MWSD or other local utilities been contacted for service connection if required?  
ONE CALL WILL BE CONTACTED UPON BEGINNING OF WORK.
15. Are plans drawn and stamped by Architect/ Engineer?  
NO

o 16. Have plans been submitted to Rutherford County Codes or Murfreesboro City Building Codes Offices for review and/or approval. (LaVergne City Codes, Smyrna City Codes, Murfreesboro City Codes)

17. What is your time line for completion of project? When will it start and when will it be completed? WITHIN 3 MONTHS OF APPROVAL

18. If stated that construction project is at no cost to school Board all cost should be included in project. This includes electrical, plumbing, and mechanical services.

N/A

19. Do you have a contractor for constructing/completing the project? What is the name of Contractor? If no, who will be overseeing the project from the community and who will be doing the work?

TITO BUTLER

BUTLER MASONRY & CONCRETE

October 28, 2019

Mr. Lee,

The Blackman Middle Softball program would like to request the approval to add a concrete slab behind the back stop, from dugout to dugout to put bleachers on. The total cost will be \$2,000 for the labor and finishing work of the concrete. Smyrna Ready Mix is donating the concrete and Tito Butler with Butler Masonry and Concrete will complete the labor.

Below is the facility map with the slabs colored/drawn as a reference for location.

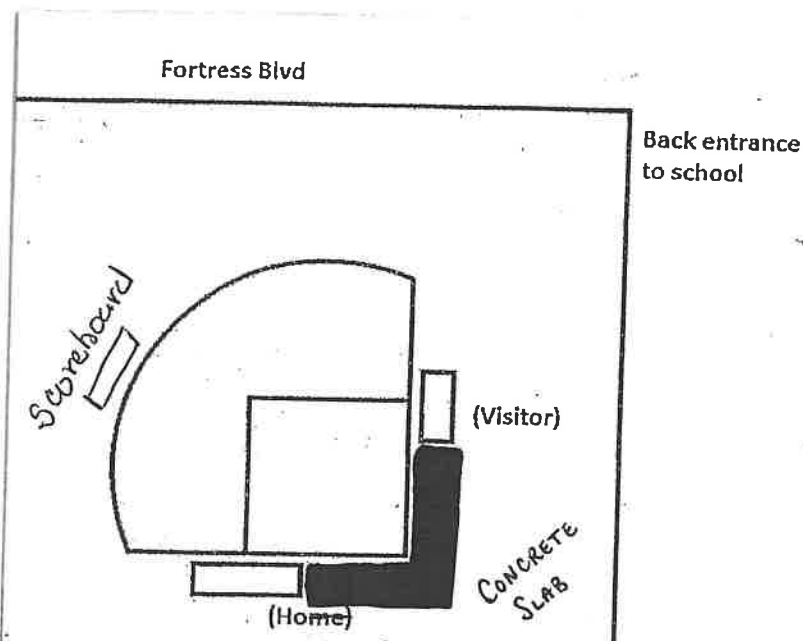

Thank you,

Megan Kelley

Blackman Middle School Head Softball Coach

Dr. Amy Connifey-Marlin

Principal



Megan Kelley <megankelley0214@gmail.com>

---

## Softball pad

---

**tito butler** <titobutler04@gmail.com>  
To: megankelley0214@gmail.com

Sat, Oct 5, 2019 at 1:42 PM

Job description 1) excavate area 2) form up pad to measurements discussed 3) bring in gravel 4) pour concrete with broom finish

Labor and gravel =\$2000.00





Rockvale High School and Rockvale Middle School would like to purchase a storage building for our soccer field. We will split this cost 50/50 and it will be placed in or near our soccer field.

Steve Luker

Date

Fred Barlow

Date

## Rutherford County Schools

### Application for Campus Construction Project

Before any request for construction of proposed buildings will be forwarded to the Rutherford County School Board, the following form must be filled out in full and submitted to the Rutherford County Schools Engineering and Construction Department with a letter from the School Principal, a site plan, floor plan, and elevations (if applicable), a full estimate and schedule

1. School Name **ROCKVALE HIGH SCHOOL**
2. Principal **STEVE LUKER**
3. Project Name **JROTC Rope Bridge Poles**
4. Assistant Principal who is overseeing the project **Jason Crutchfield**
5. Does project support recreational sports, athletics or education? **YES**
6. Does this project meet all gender equity criteria? **YES**
7. What department is this project being constructed for? (I.E. Baseball, Softball, Band, FFA, etc)  
**ARMY JROTC**
8. What is the anticipated cost for this project (this should include all utility connection fees, building permits, permits, inspection and construction). Attach and submit a detailed estimate.  
  
**The anticipated cost for this project is \$0.00. There is no utility connection fee, no building permits, no permits, no inspection and no construction. The poles are being donated and the parents of the cadets are providing the equipment to dig the holes and plant them.**
9. What is the funding source and are funds currently available: **No funds are required**
10. If a grant or funded by a foundation/donor/charitable organization, what is the foundations name? **Not Applicable**  
Do construction plans meet criteria for funding? **There are no construction plans.**  
  
This project is not funded by a local financial institution. **There is no funding for this project.**
11. Do you have a site layout showing where this project will be constructed on campus? **See attached**
12. Has RCS Engineering & Construction reviewed project location? Are there any conflicts in utilities or easements? **RCS E&C has been contacted and is reviewing the location.**

13. Has MTEMC, CUD, MWSD, or other local utilities been contacted for service connection if required? **No utilities will be required or connected. TNOneCall was contacted (work order attached) for notification of utilities.**
14. Are plans drawn and stamped by architect / engineer? **No plans are required**
15. Have plans been submitted to Rutherford County Codes or Murfreesboro City Building Codes Offices for review and/or approval? (LaVergne City Codes, Smyrna City Codes, Murfreesboro City Codes) **There are no plans to submit.**
16. What is your time line for completion of project? When will it start and when will it be completed? **Timeline is as soon as possible. It will be completed when the four sixteen-foot poles are planted in the ground.**
17. If stated that construction project is at no cost to school board all cost should be included in project. This includes electrical, plumbing, and mechanical services. **There are no electrical, plumbing or mechanical service costs.**
18. Do you have a contractor for constructing/completing the project? What is the name of the contractor? If no who will be overseeing the project from the community and who will be doing the work?